

MOMENTARY ACTION

The PE2 with solder termination is qualified under MIL-PRF-8805/99. The PE2 is a rugged sealed switch; it meets high shock and vibration requirements and is ideal for tough environments. A variety of button colors and easy panel mounting options are provided. The PE2 is a momentary 2 circuit or DPDT, and has a 2A resistive 1.5A inductive 28VDC/115VAC rating. Splashproof with panel seal dress ring per MIL-PRF-8805, symbol 6.

Features:

- MIL-PRF-8805/99 qualified
- Momentary snap-action
- Black, white or red button colors available
- Splashproof
- RoHS compliant

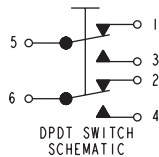
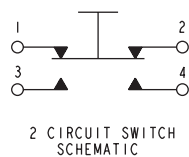
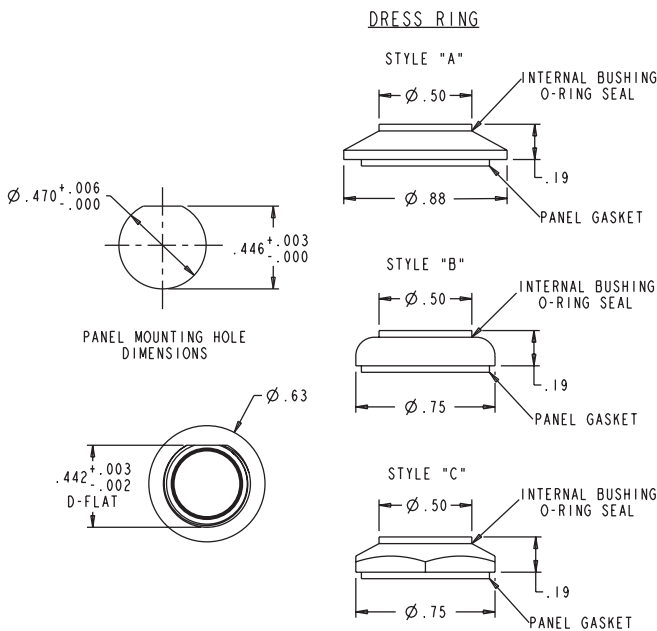

Standard Characteristics/Ratings:		
ELECTRICAL RATINGS:		
Load	Sea Level @ 28VDC or 115VAC, 60/400Hz	70,000 feet @ 28VDC or 115VAC, 60/400Hz
Resistive	2A	2A
Inductive	1.5A	1.5A
Lamp	0.5A	0.5A
DWV	1000Vrms	500Vrms
Electrical Life:	25,000 cycles at full load	
Mechanical Life:	50,000 cycles	
Seal:	Splashproof with panel seal dress ring per MIL-PRF-8805, symbol 6	
Operating Temp Range:	-55°C to +85°C	
Operating Force:	4.5 lbs. +/- 1.5 lbs.	
Total Travel:	0.176 inches max	
MATERIALS:		
Case:	Anodized aluminum alloy, black	
Button:	Thermoplastic	
Terminals:	Brass, silver plate	
Mounting Hardware:	Hex nut, lockwasher, keying washer, dress ring with O-ring seal, panel gasket when applicable	

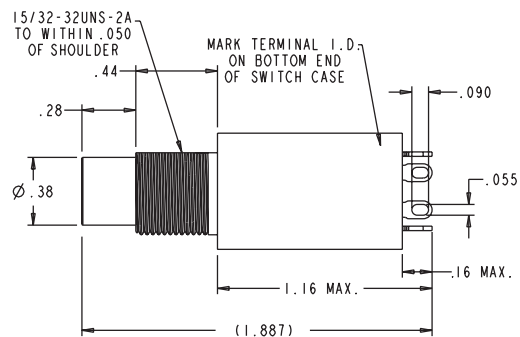

PE2 PART NUMBER CODE

